

bathmate®

J U S T A D D W A T E R

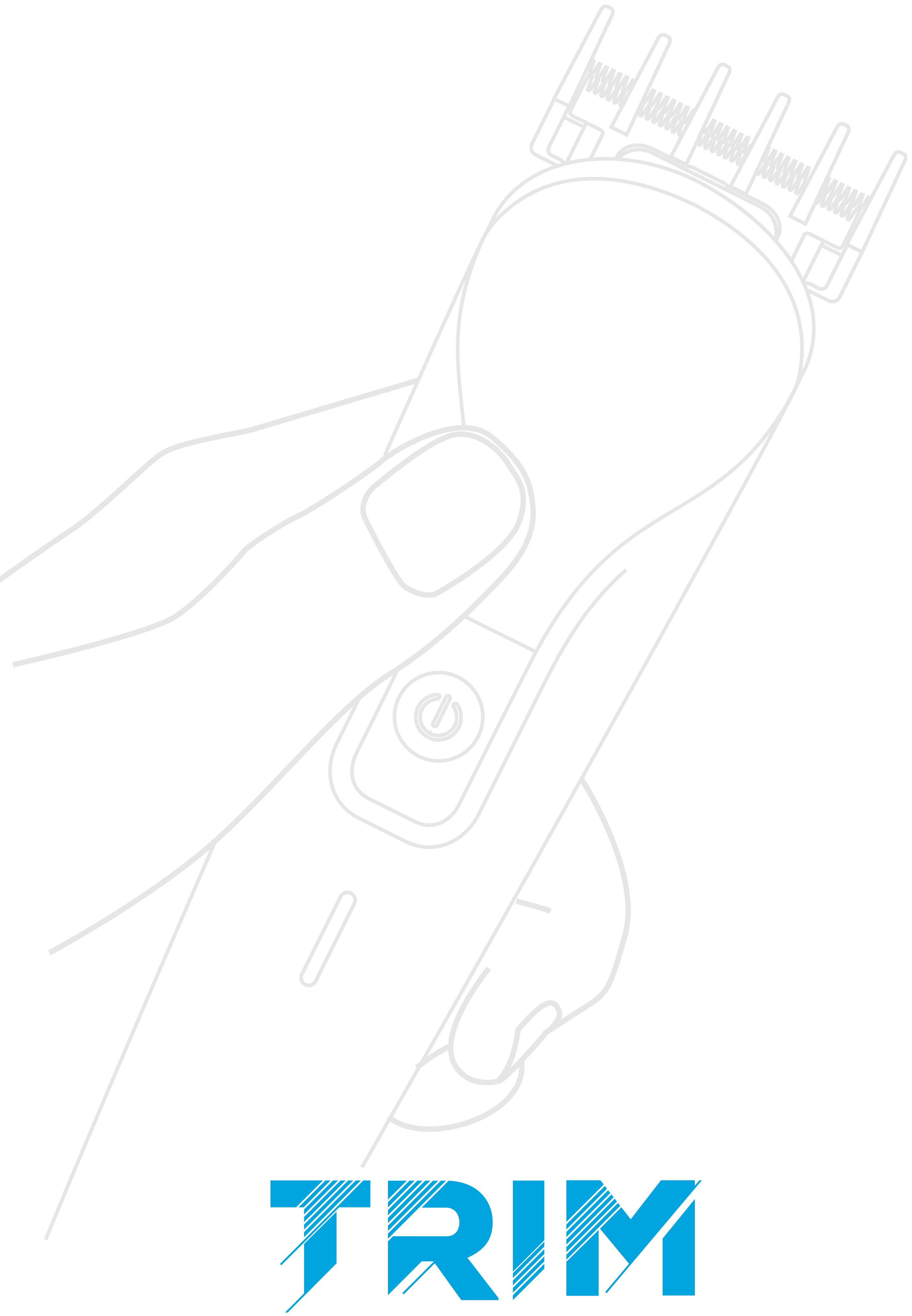

TRIM

U S E R G U I D E

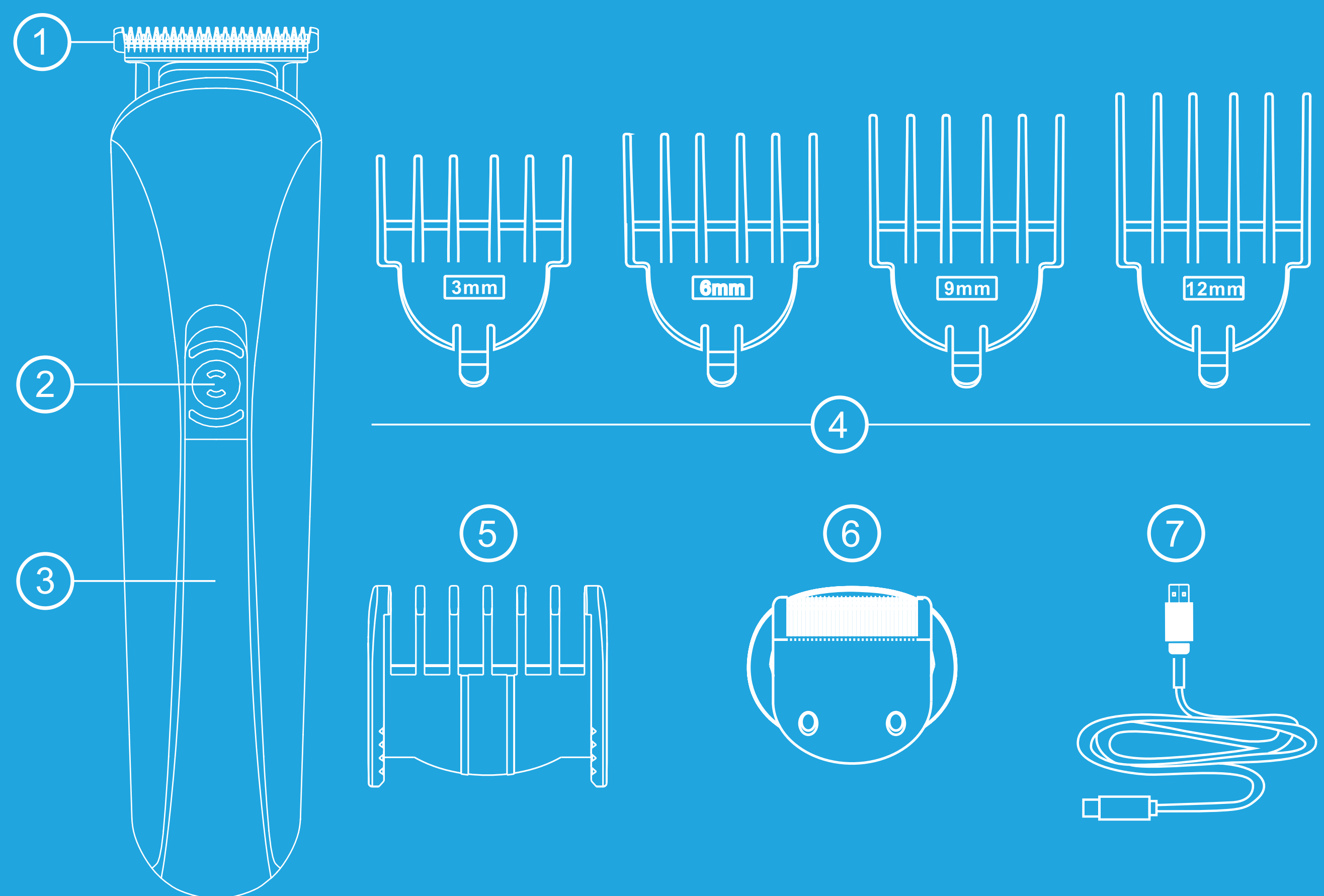

1. Full size trimmer

2. On/off switch

3. Charging indicator light

4. Guide combs for full size trimmer

5. Guide comb for precision trimmer

6. Precision trimmer

7. USB charging cable

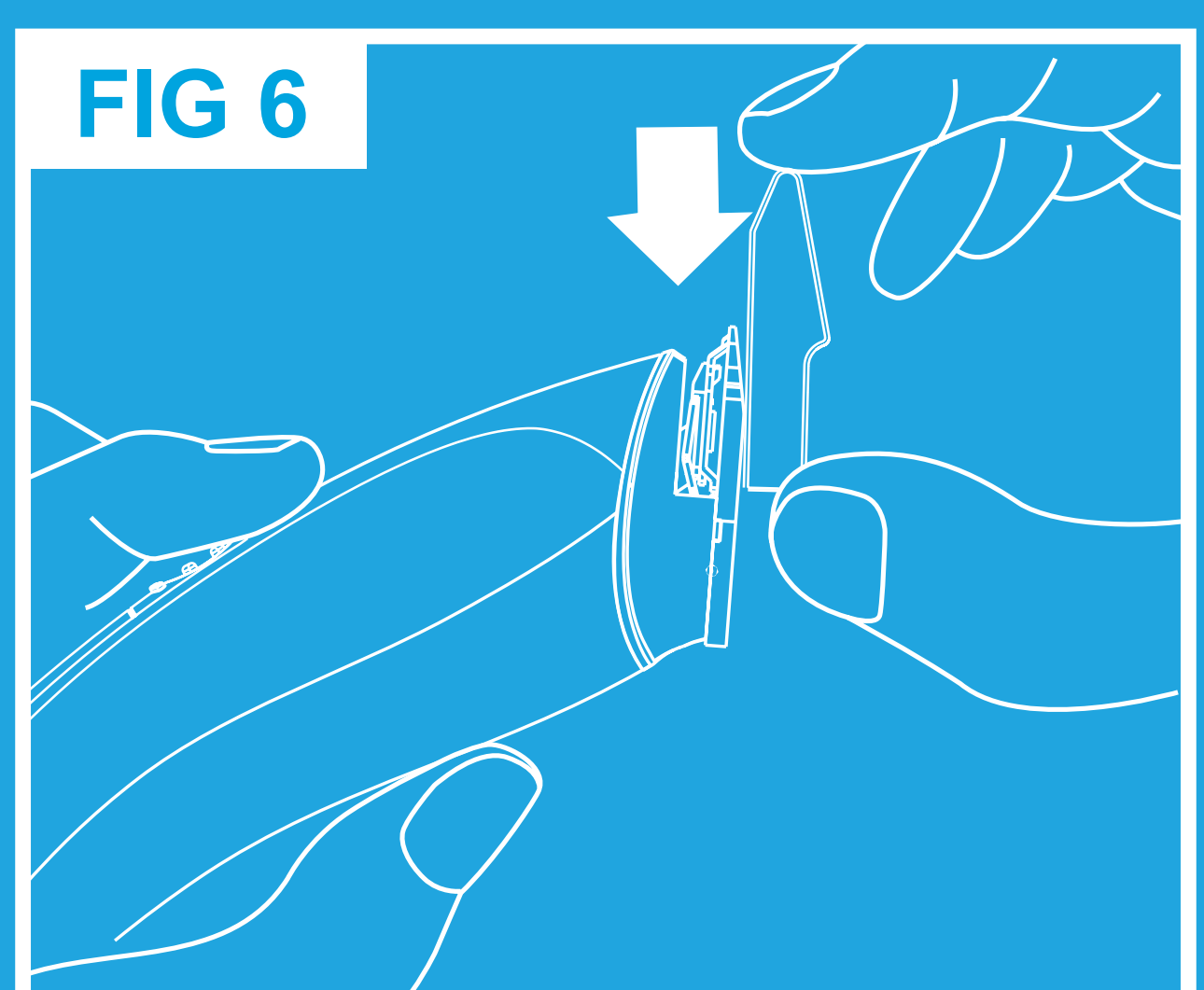
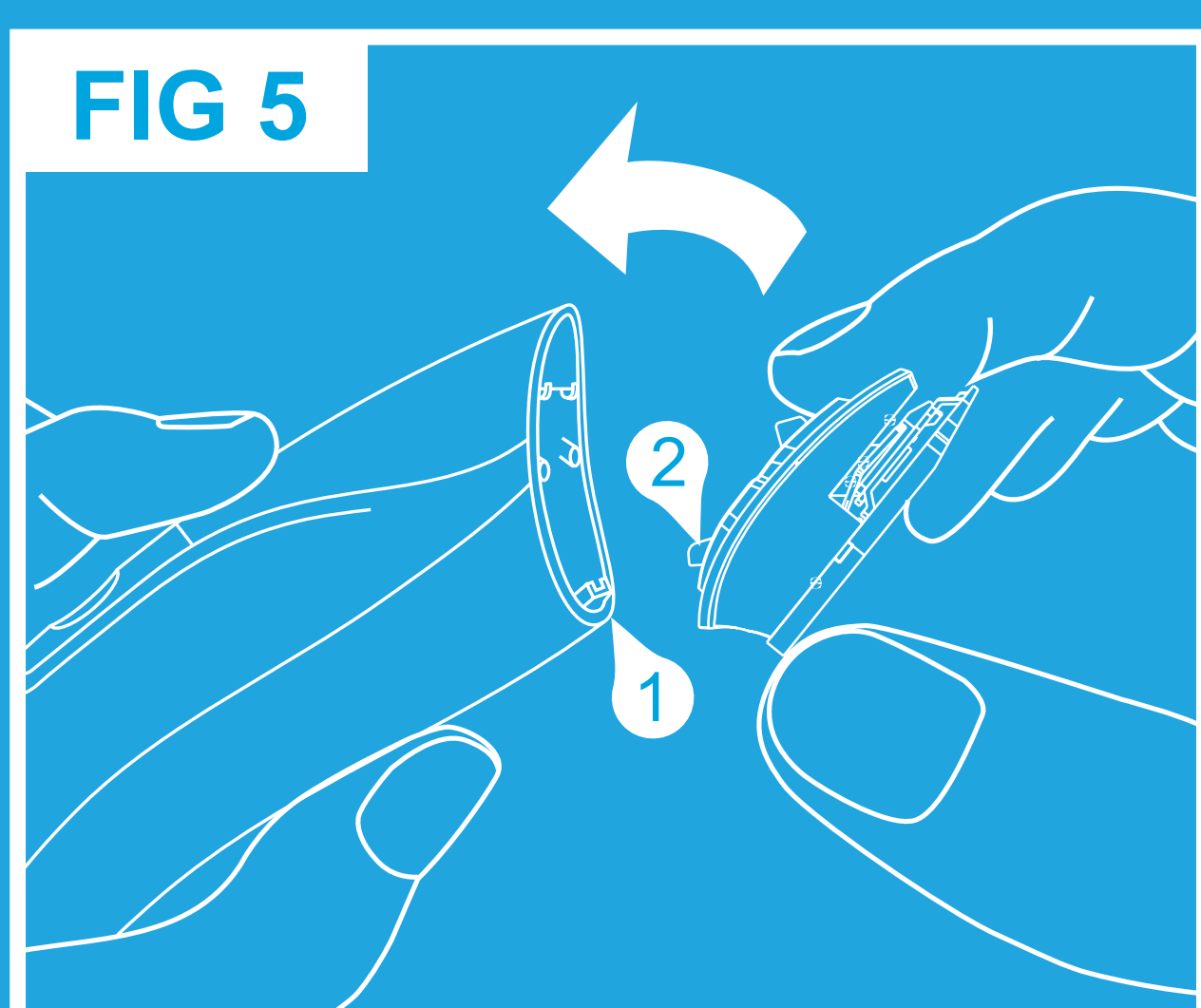
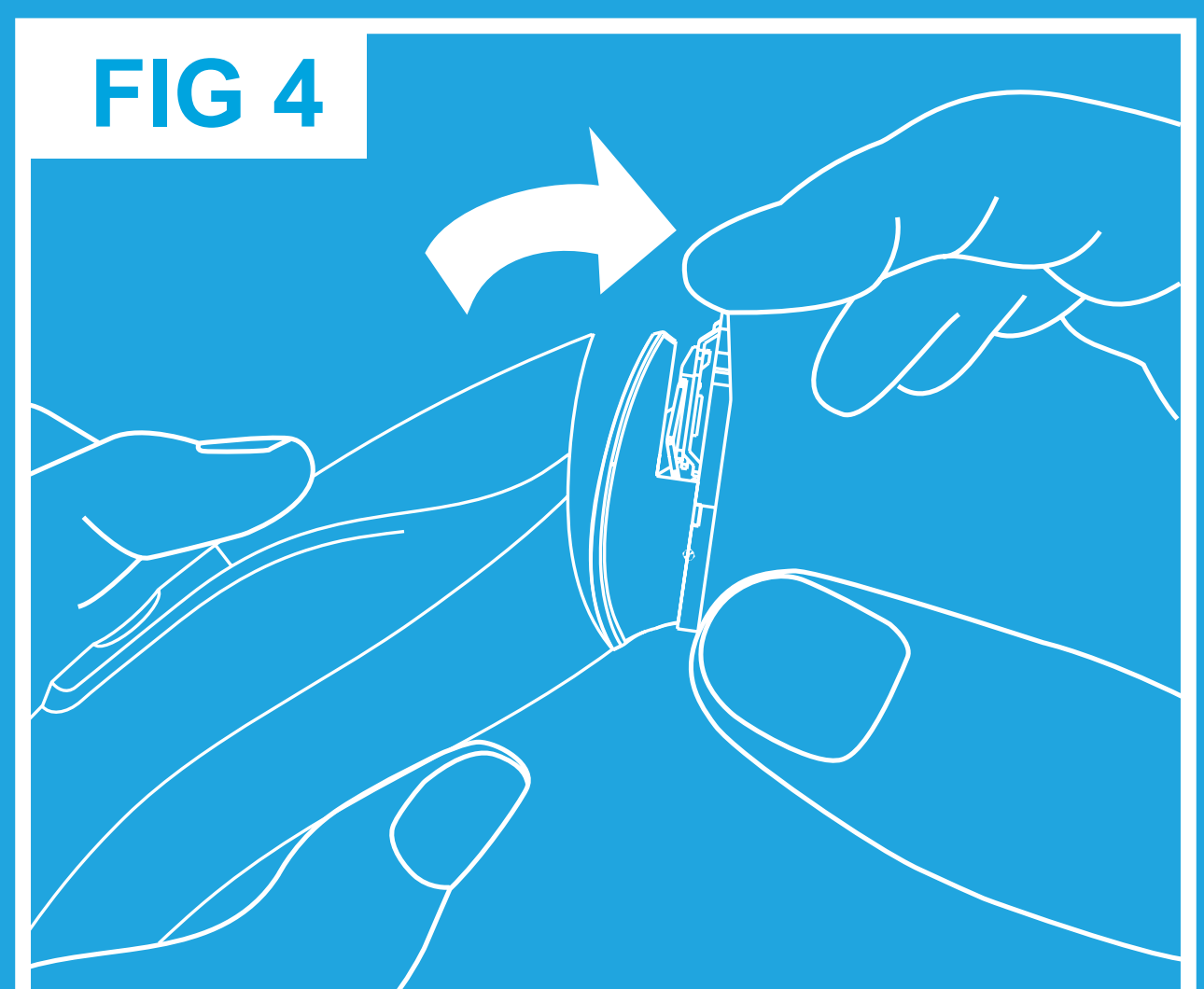
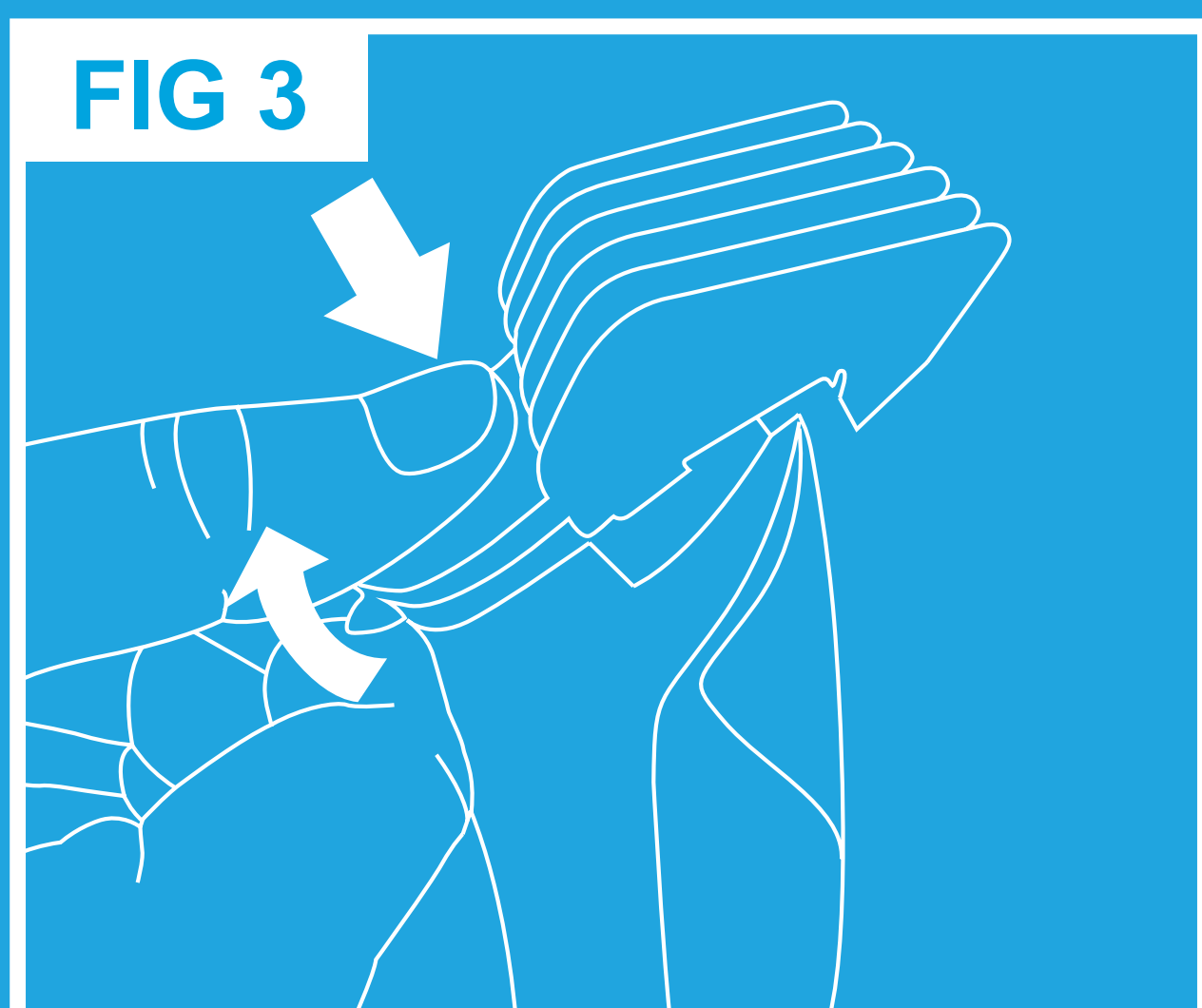
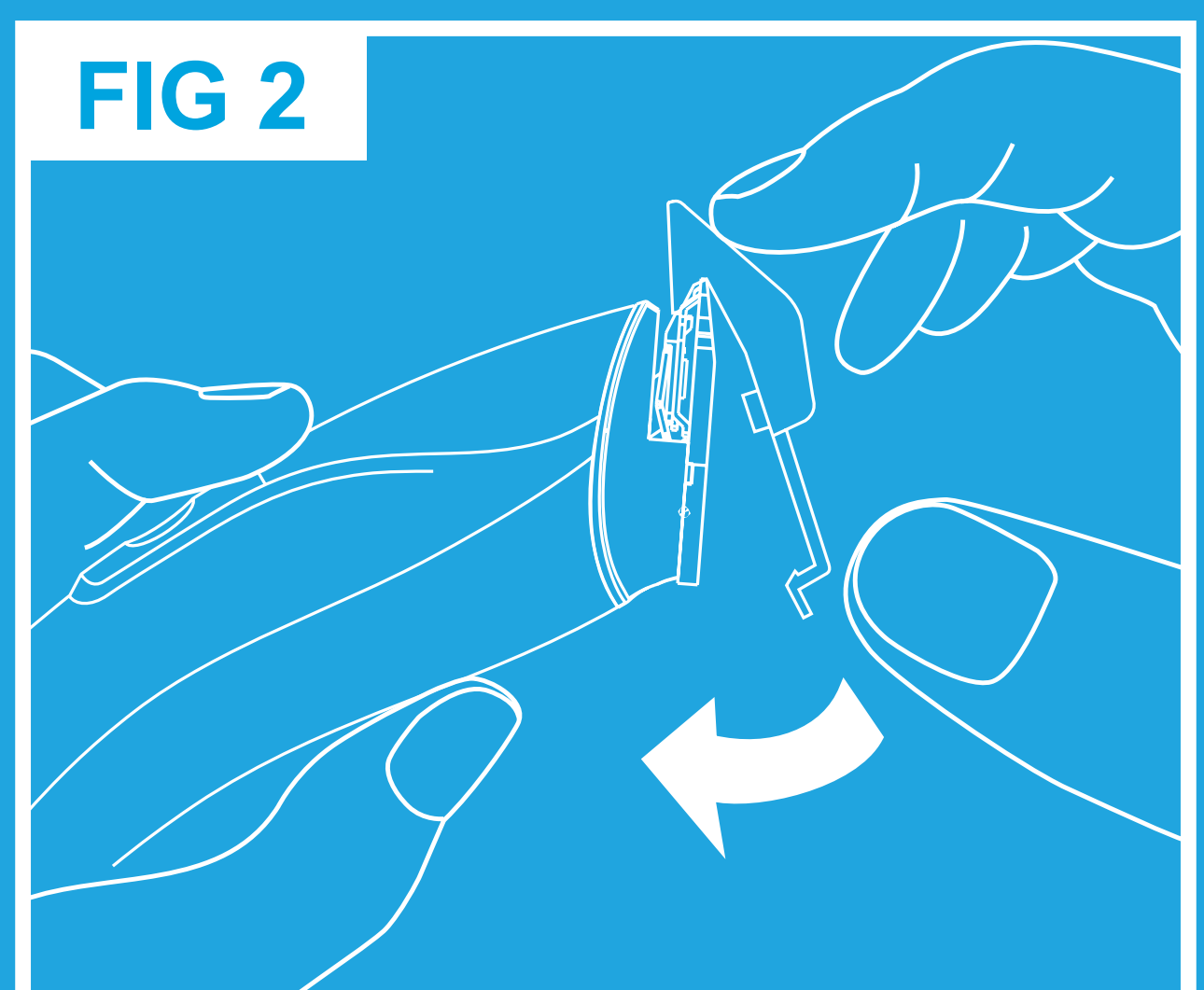
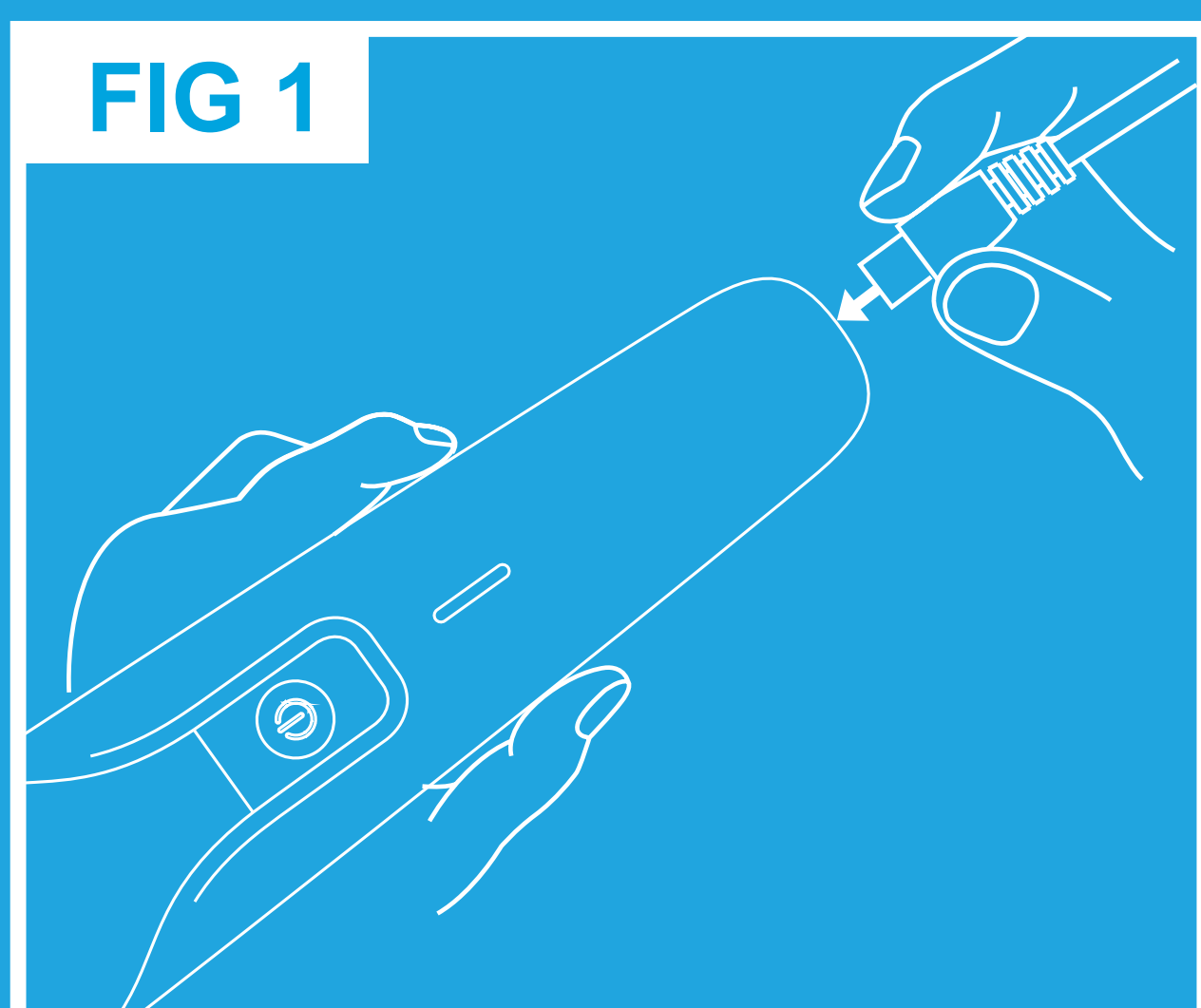

BEFORE GETTING STARTED

IMPORTANT SAFETY INSTRUCTIONS

WARNING - TO REDUCE THE RISK OF BURNS, ELECTROCUTION, FIRE OR INJURY TO PERSONS:

- Use this appliance only for its intended purpose, as outlined in this guide.
- Do not use this product if it is not working correctly, if it has been dropped or damaged or if it has been dropped in water.
- This appliance should never be left unattended when plugged into a power outlet.
- Keep this appliance away from heated surfaces.
- Ensure that the power cord does not get wet.
- Do not plug or unplug the appliance with wet hands.
- Do not use this appliance whilst connected to a power outlet.
- Do not twist or kink the cable or wrap it around the appliance.
- Do not connect the charging cable if it is damaged.
- Charge, use and store this appliance at a temperature between 15°C and 35°C.
- Do not use any attachments other than those supplied with this appliance.
- Always unplug the appliance when disassembling.
- Do not immerse this appliance in liquid; do not use it near water, in a bath-tub/shower, a basin and do not use outdoors.
- Keep this appliance out of the reach of children. The use of this appliance by persons with reduced physical, sensory or mental capabilities or lack of experience and knowledge can give cause to hazards. Persons responsible for their safety must give explicit instructions or supervise the use of this appliance.

GETTING STARTED

CHARGING YOUR APPLIANCE:

Before using your Bathmate Trim for the first time, charge for 8 hours.

- Ensure the product is switched off.
- Connect the charging cable to the appliance and then into the mains (fig 1). The charging indicator light will light up.

CHARGE LEVEL INDICATORS:

Charging - LED will illuminate RED

Fully Charged - LED will illuminate GREEN

- Your Bathmate Trim cannot be overcharged. However, if it is not going to be used for an extended period of time (2-3 months), unplug it from the mains and store. Fully recharge the appliance when you wish to use it again.
- To preserve the life of your batteries, let them run out every 6 months then recharge for 8 hours.

INSTRUCTIONS FOR USE

Please note: This appliance is designed for cordless use only and should never be used when connected to the mains.

- Switch the appliance on by pressing the on/off switch

Attaching and removing the trimming attachments

- To attach the guide combs onto the full size trimmer, slide the desired comb into position and click into place (fig 2).
- To remove the guide combs, press down on the flat part of the comb with your thumb and pull upwards with your index finger (fig 3).
- To attach the precision trimmer, firstly remove the full size trimmer by pressing down on the flat part with your thumb and pull upwards with your index finger (fig 4).
- Attach the precision trimmer by aligning the base of the head with the lock and click into position (fig 5).
- To attach the precision trimmer guide comb, slide the comb over the blade and click into position (fig 6). Slide the comb up and down to desired length, as indicated on the comb. To remove, slide the comb up and off the trimmer.

ADJUSTABLE COMB CUTTING LENGTHS

1. 4mm
2. 4.5mm
3. 5mm
4. 5.5mm

CARE FOR YOUR BATHMATE TRIM

To ensure a long lasting performance, we recommend that you clean your Bathmate Trim after each use.

- Always ensure that the appliance is switched off before cleaning.
- Brush any accumulated hairs from the trimmer and attachment heads.
- The trimmer body should not be rinsed.
- Place 1 or 2 drops of cutter oil or sewing machine oil on the blades.
- Turn the trimmer on to distribute the oil evenly. Wipe away any excess oil.

CLEANING PRECAUTIONS:

- Only the guide comb attachments and trimmer head can be removed from the appliance for cleaning.
- Cleaning should only be done with a soft brush.
- Do not use harsh or corrosive cleaning products on the unit or blades.
- Do not submerge in water as damage will occur.

BATTERY REMOVAL

- The battery must be removed from the appliance before it is discarded.
- Ensure that the appliance is fully discharged of all power.
- Remove the attachment head from the unit.
- Using a small screwdriver unscrew the back of the unit housing and carefully pry off.
- Open the rear housing to expose the printed circuit board.
- Disconnect the wires which connect the battery to the circuit board and remove the battery.
- Dispose of the battery safely.
- Never attempt to remove the battery whilst connected to a power outlet.

ENVIRONMENTAL PROTECTION



To avoid environmental and health problems due to hazardous substances in electrical and electronic goods, appliances marked with this symbol must not be disposed of with unsorted municipal waste, but recovered, reused or recycled at the end of its usable life.

Do not discard this appliance in a fire or mutilate the battery as this gives cause for the release of toxic materials.

WARRANTY

The Bathmate Trim is designed to provide many years of trouble free use. It is covered by a 1 year warranty against defective parts or poor workmanship. Full details of the warranty and what to do in the unlikely event that your Trim is faulty can be found at:

<https://support.bathmatedirect.com>